

**Product overview:**

AAFD offers radiation door sets featuring lead-lined construction. These sets are meticulously crafted to offer superior shielding against dangerous radiation, particularly in environments prone to radiation hazards. These specialized doors/frames play a vital role in medical institutions, industrial sites, research facilities, and similar locations where safeguarding against radiation exposure is essential. Their design is optimized to reduce radiation seepage, thereby guaranteeing the well-being of personnel and the nearby surroundings.

**Radiation Doors:**

Our radiation doors are lead-lined and available with different lead thickness options to provide varying levels of radiation shielding. Thicker lead layers offer higher levels of protection, suitable for areas with higher radiation levels or specific regulatory requirements.

**General Lead Rating/ Thickness:**

5KG/m<sup>2</sup> = 0.45mm

10KG/m<sup>2</sup> = 0.88mm

15KG/m<sup>2</sup> = 1.32mm

20KG/m<sup>2</sup> = 1.76mm

25KG/m<sup>2</sup> = 2.2mm

**Laser Flaps:**

Laser flaps on radiation doors are advanced safety features meticulously designed to optimize functionality and safety within radiation treatment rooms found in medical facilities. These specialized flaps are seamlessly integrated into the structure of radiation doors, serving a multitude of crucial purposes.

**Various PVC Finishes Including:**

- Acrovyn
- Acculine
- Coroguard
- LI Door Protection HPL

**Extras:**

- Stainless Steel Kick Plates
- Vision Panels
- ABS & Timber Edging
- Timber Bead
- Aluminium and Stainless Surrounds
- Radiation Flaps
- Double Glazed Venetians

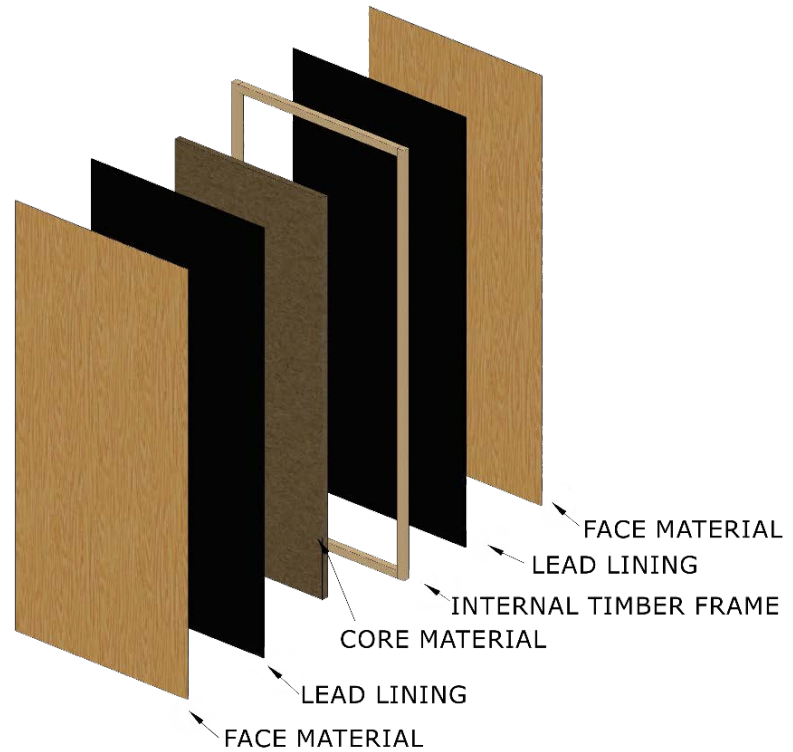

Radiation doors can also be supplied with varying Fire Resistant Levels (FRLs).

**Radiation Door Frames:**

AAFD offers lead-lined door frames, which are specially engineered to complement our radiation doors. Our frames provide comprehensive radiation shielding, sound insulation, and fire resistance.

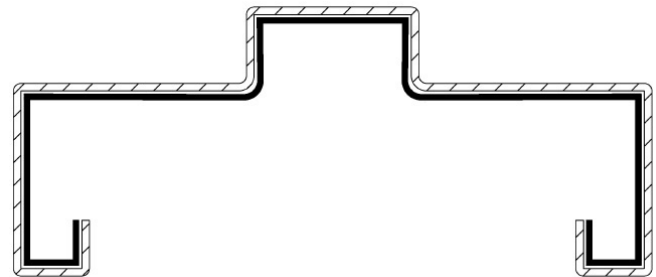

**Application of Radiation Door sets:**

- Dental offices and surgeries
- OPG/CBCT rooms
- Operating theaters
- Diagnostic imaging facilities (X-ray, CT scan rooms)
- Laboratories
- Veterinary clinics

**Specification:**

Due to the significant variation in options and the diverse radiation containment needs which are based on specific situations, we encourage you to reach out to us for guidance in crafting a tailored specification.